



DESTROYER SERIES

TRUCK

FRONT GRILL GUARD



VERIFY YOU HAVE ALL THE COMPONENTS BEFORE STARTING THE INSTALLATION. REFER TO THE ENGINEERING DRAWINGS AT THE END OF THIS DOCUMENT FOR A COMPLETE PARTS LIST

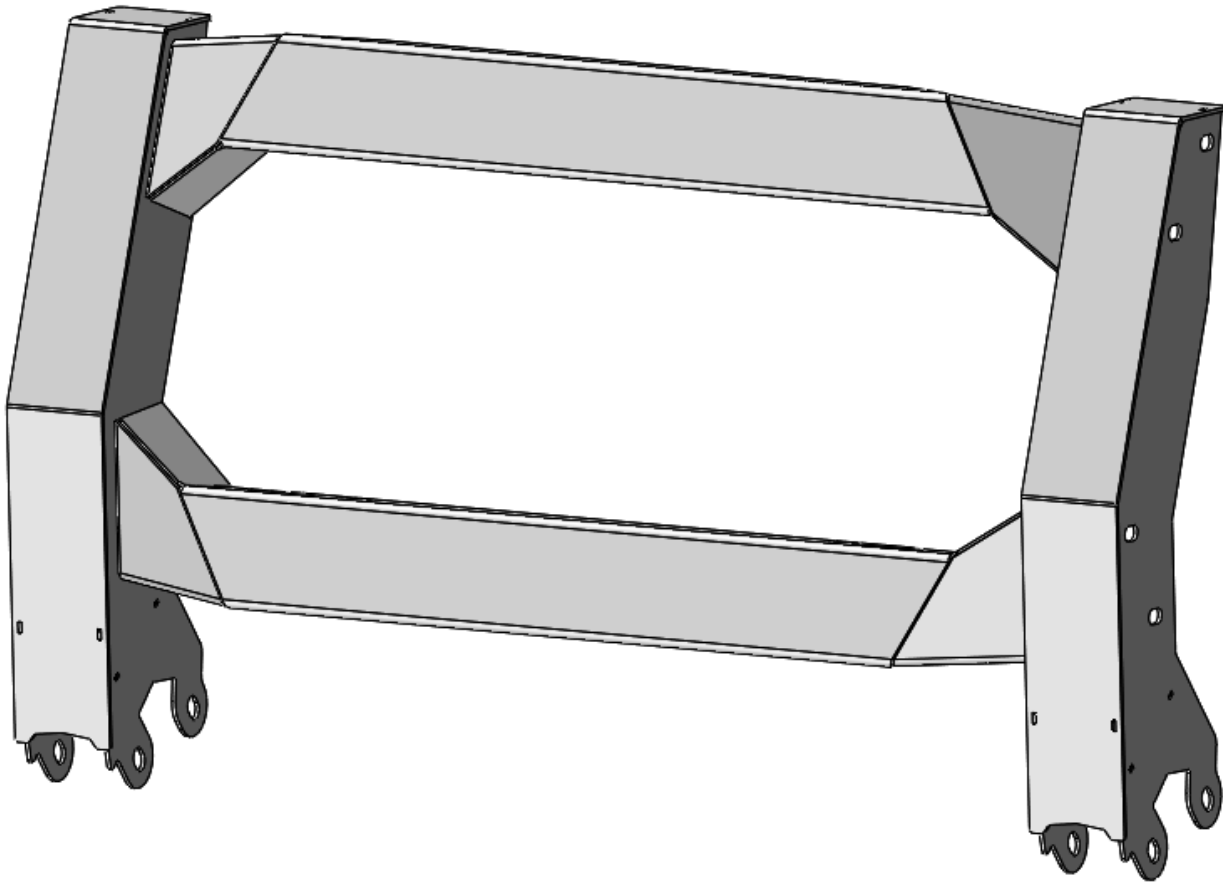

Remove the two upper Ø1/2" Bolts that connect your Bumper Center thru the Tow Point and Wing.

This picture shows the Wing removed for clarity. ****Do not remove the Wing.****

Leave the lower two Bolts in place and tight during the Bull Bar installation. This will keep your Wing from changing positions during installation.

Remove these two bolts

Leave these in place and tight

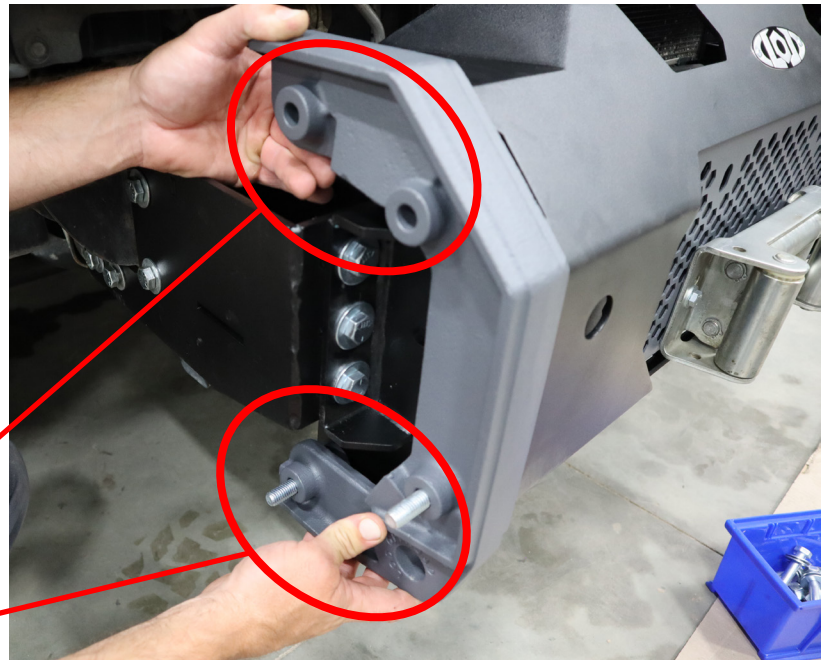

Next install the Tower Bars as shown into the slots at the top of the bumper and wing. Reinstall the Ø1/2" Hex Bolts thru the bumper, wing, tow points and Tower Bar. Leave these bolts loose while your finish the installation.

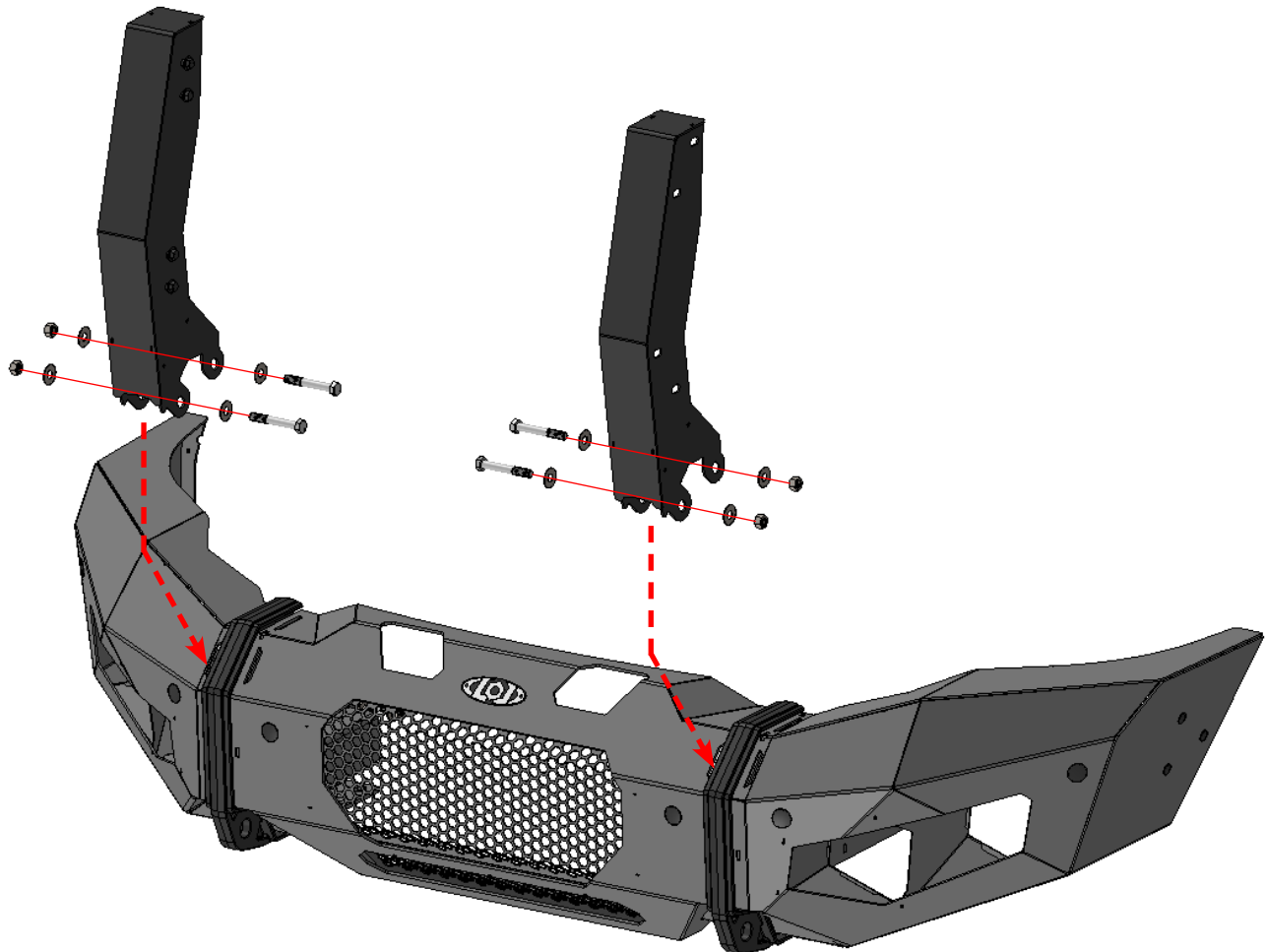

Next loosely assembly the Center Bars as shown between the towers using the Ø3/8" Hex Bolts.

Position the Center Bars and Towers as needed and tighten the Ø3/8" Hex Bolts securely.

With the Front Grill Guard in its final position, tighten the remaining four Ø1/2" Hex Bolts that connect the Grill Guard to your bumper.

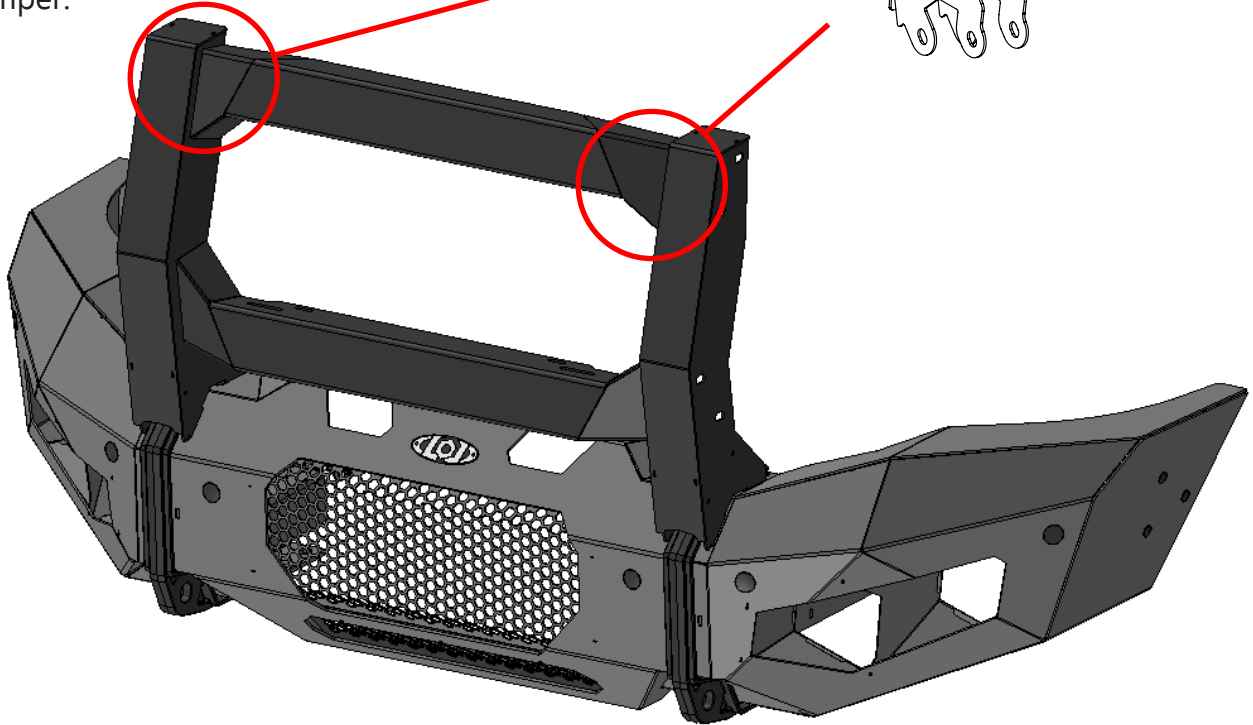
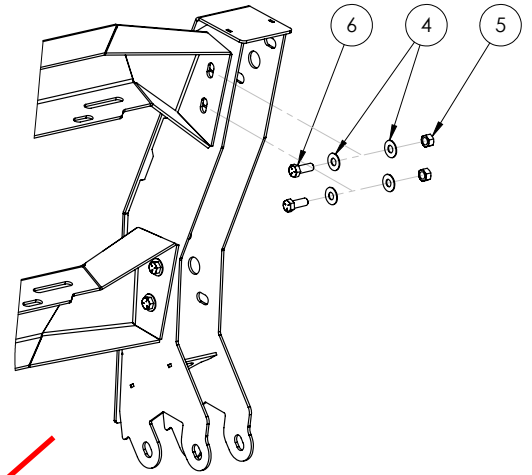

****Maintenance****

- Periodically check and re-tighten all fasteners.
-
- Periodically check your product for scratches, dings, or rust spots which can happen over time or after heavy use. It is important to address these areas as soon as possible to prevent rust and corrosion from spreading. We recommend using Rustoleum® brand Black Semi-Gloss Protective Enamel (oil based). Apply using a foam brush by dabbing to match the powder coat texture.



ITEM NO.	PART NUMBER	DESCRIPTION	QTY.
1	4MFG2020-02	CENTER BAR	2
2	4MFG2020-11	TOWER BAR - PS	1
3	4MFG2020-12	TOWER BAR - DS	1

BOLT KIT

ITEM NO.	PART NUMBER	DESCRIPTION	QTY.
4	FW3114ZP	FLAT WASHER Ø5/16" X .875" ZINC PLATE	16
5	HN3816ZPGR5	HEX NUT 3/8-16 ZINC PLATE GR5	8
6	HB381616ZPGR5	HEX BOLT 3/8-16 X 1.00 ZINC PLATE GR5	8

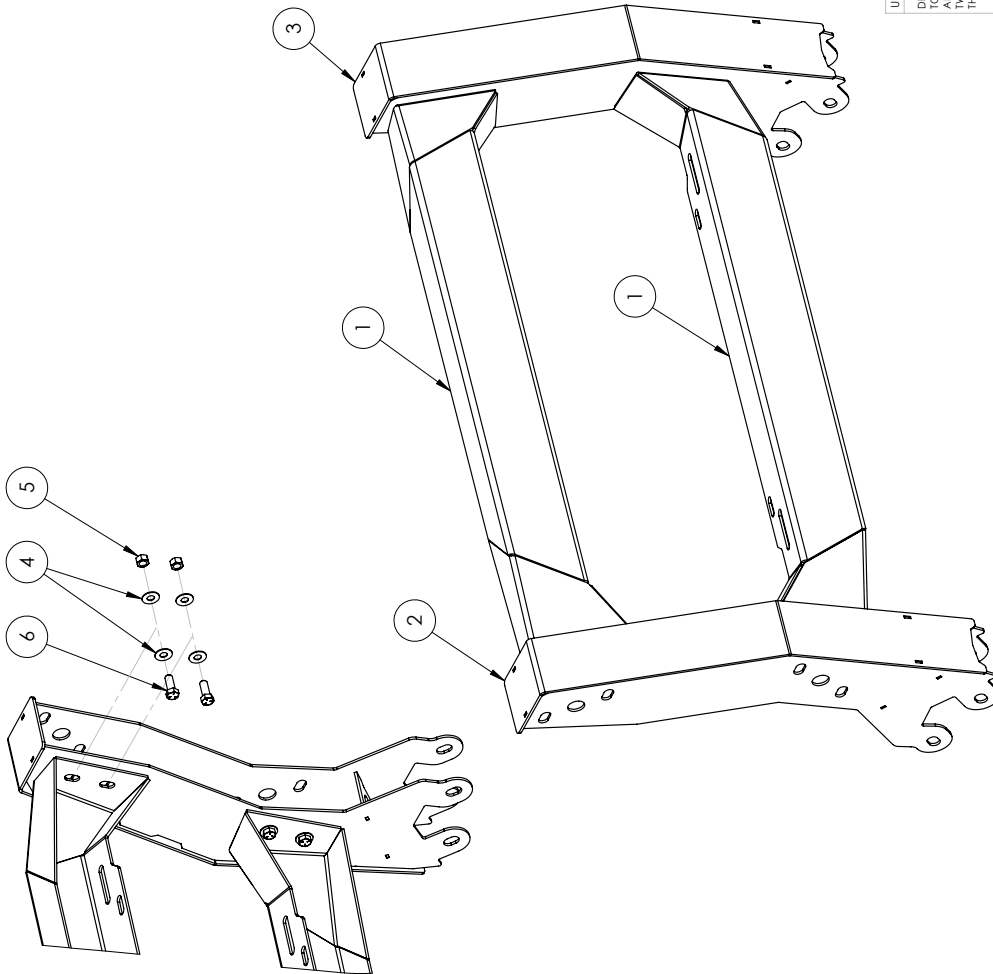

- NOTES:**
1. MFG2022 = BARE STEEL OPTION
2. MFG2023 = BLACK POWDER COAT

UNLESS OTHERWISE SPECIFIED: DIMENSIONS ARE IN INCHES TOLERANCES: ANGULAR: MACH: ±1° TWO PLACE DECIMAL ±0.015 THREE PLACE DECIMAL ±0.005	DRAWN CHECKED ENG APPR. MFG APPR.	NAME MCH	DATE 6/14/2021
LOD LLC. DESCRIPTION: DESTROYER MOD FRONT GUARD			
PROPRIETARY AND CONFIDENTIAL THE INFORMATION CONTAINED IN THIS DRAWING IS THE SOLE PROPERTY OF LOD LLC. ANY REPRODUCTION IN PART OR AS A WHOLE WITHOUT THE WRITTEN PERMISSION OF LOD LLC IS PROHIBITED.			
DWG. NO. MFG2022 MFG2023	REV A	SCALE: 1:6	SHEET SIZE: B
SHEET 1 OF 1			



TRUCK
DESTROYER SERIES
CENTER GRILL GUARD
SHIPPING SHEET

Packaged by:

On:



INSTRUCTION
SHEET

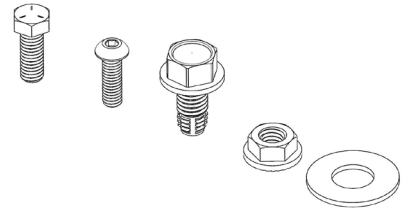

BOLT KIT
(may vary)

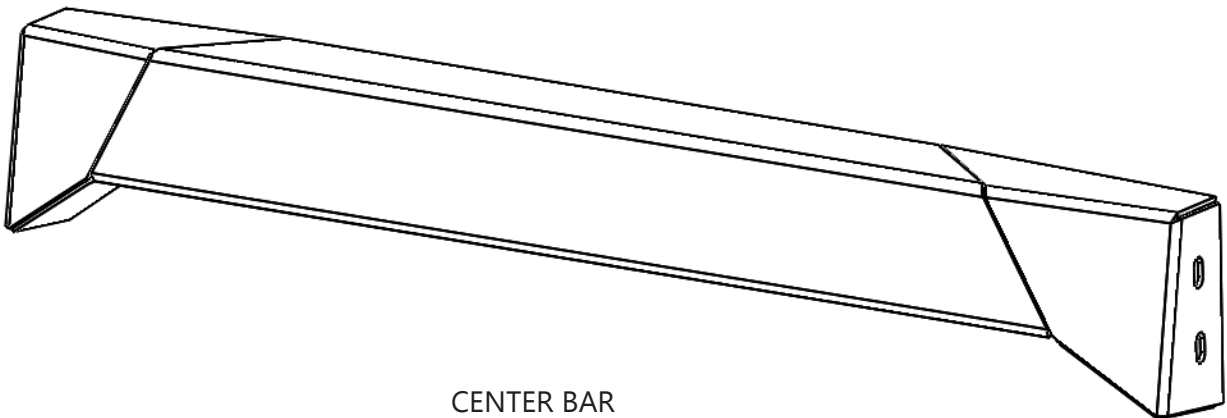
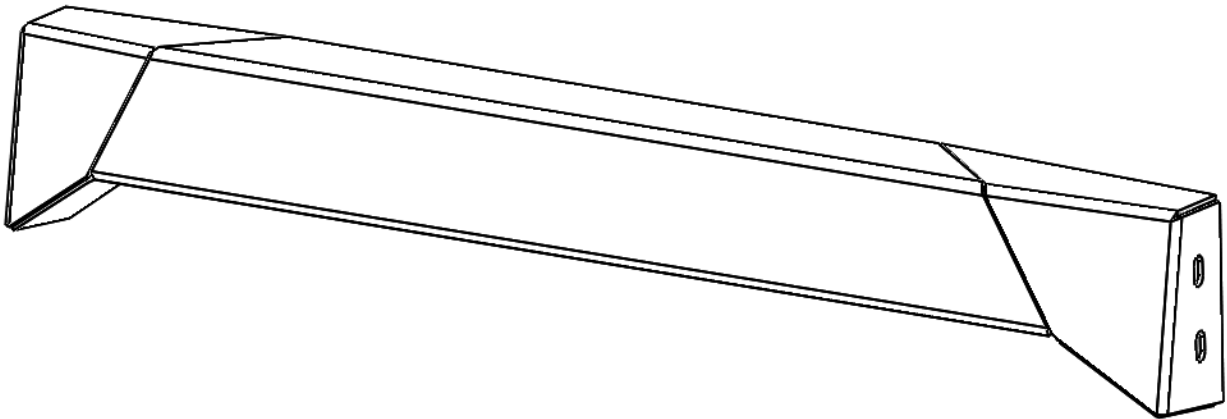

CENTER BAR
4MFG2020-02
(x2)



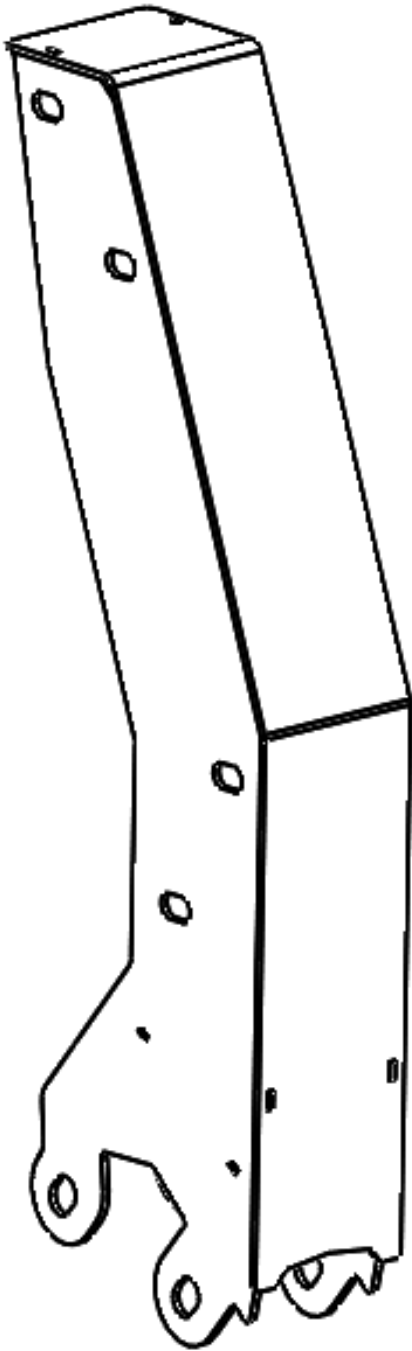

TOWER BAR - PS
4MFG2020-11
(x1)

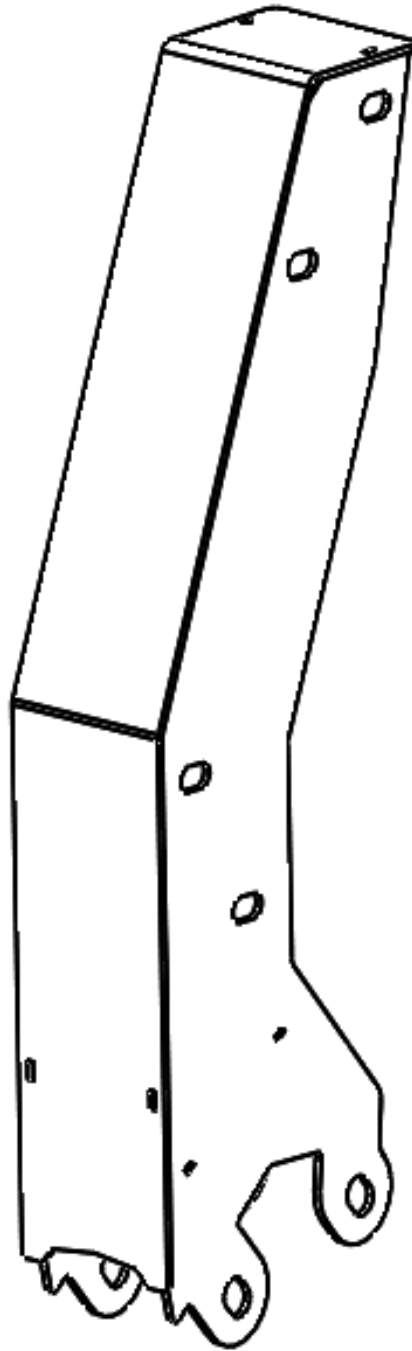

TOWER BAR - DS
4MFG2020-12
(x1)





TRUCK
DESTROYER SERIES
CENTER GRILL GUARD

Bolt Kit

Packaged by:

On:

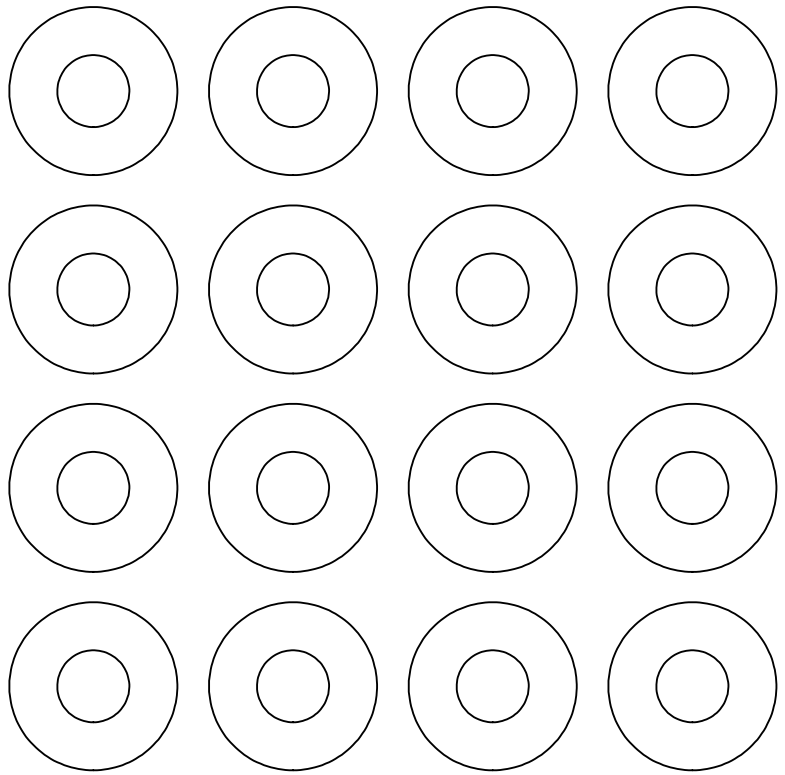

FLAT WASHER
Ø5/16" X .875"
(0159722)
(x16)

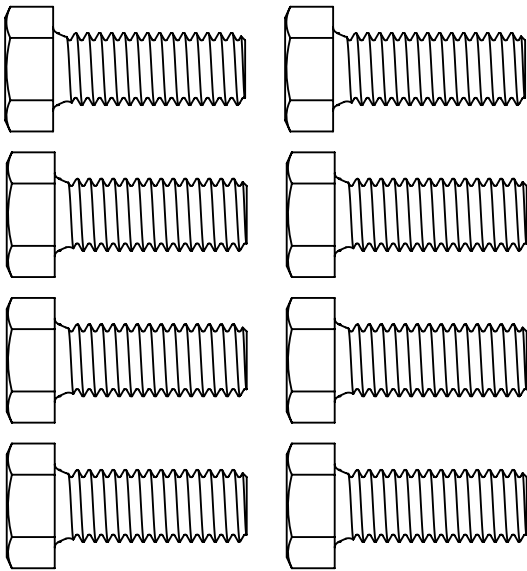

HEX BOLT 3/8-16 X 1.00"
(0137514)
(x8)

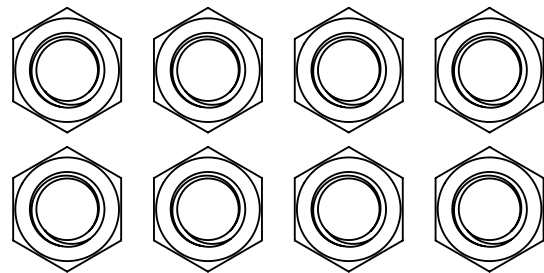

HEX NUT 3/8-16
(0147966)
(x8)

